

C300 Series - External Cage Cage for Liquid Level Controls

Application – External Cage; Working Pressure up to 5000 psig

- Use in applications where level controls are contained outside of the vessel itself
- May be used with most Pathway level controls or with others meant for similar application
- Use on production separators, heaters/treaters, scrubbers, liquid accumulators & process vessels in most applications
- Available with a variety of connections as needed for most applications



Features

- Heavy Duty Rugged Construction
- Available in Ductile, Carbon Steel or Stainless Steel
- Purchase combined with Pathway Liquid Level Control or separately

Specifications

Working Pressure:	Pressures up to 5000 psig
Temperature:	-40° F to +450° F
Materials:	Ductile, Carbon Steel and 316 Stainless Steel available
Connections:	
Process:	1" NPT standard, available in 1 1/2" and 2" NPT; also in socket weld connections (not on ductile) of 1", 1 1/2" and 2"
Level Control:	1 1/2" NPT, 2" NPT, or Ring Bolted connection

Benefits of ALL Pathway Control Products

- Personalized service and support expertise
- Time-tested & proven design providing dependability and reliability in the field
- Custom applications welcomed to meet your needs
- Quality built in
- Responsive, On-time delivery

C300 Series – External Cage Cage for Liquid Level Controls

Dimensional Sketch: Ductile, Carbon Steel, Stainless Steel; WP up to 5000 psig

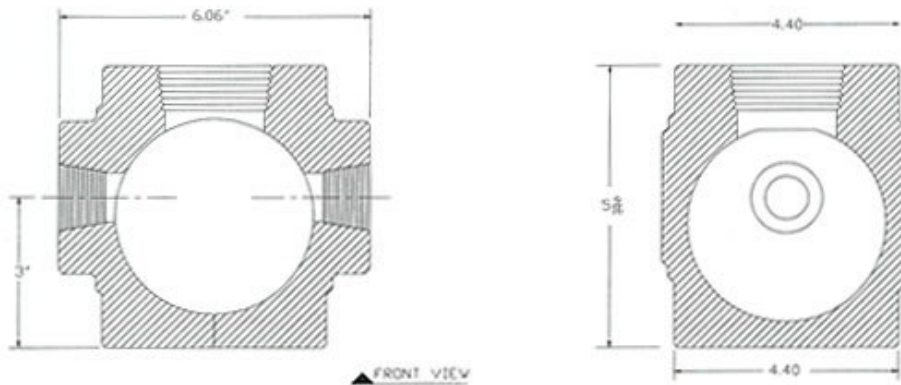

Ordering Chart:

C300: External Cage for Level Controls – Ductile standard
C300CS: External Cage – Carbon Steel
C300SS: External Cage – Stainless Steel

Level Control Connections:

1 1 1/2" NPT Connection Standard
2 2" NPT
3 Ring bolted steel, max. pressure 3000 psig

Process Connections:

1 1" NPT Standard
2 1 1/2" NPT
3 2" NPT
6 1" Socket Weld (not on ductile)
7 1 1/2" Socket Weld (not ductile)
8 2" Socket Weld (not ductile)
5 Other Process Connections as requested

Other:

00 No sight glass
01 Sight glass, 1 1/2" NPT connection
02 Sight glass, 2" NPT connection
05 Customer Specified Requirements (such as flange size)
Option (): Assigned based upon Customer Specific requirements

Example:

C300-

1

1

01

Example as Selected

C300 - 11 - 01