

P120 Series

Snap Acting Non-Bleed Pneumatic Level Control

Application – High & Low Liquid Level Control; WP 1500 psig to 5000 psig

- Float-actuated Pneumatic Switch for High or Low Level control or to operate Control Valves
- Use on production separators, heaters/treaters, scrubbers, liquid accumulators & process vessels
- Stainless Steel construction for use with most Liquids or Liquid interfaces
- Low Specific Gravity of .5 and above
- Snap Acting Non-Bleed from 0 to full supply
- Direct mounting inside vessel or External Float Cage

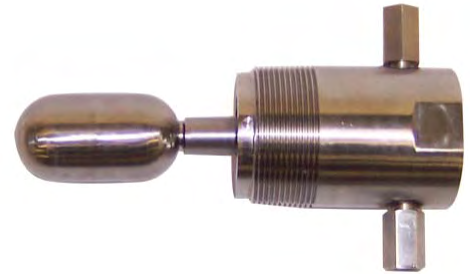

Features and Benefits of the Pathway P120

- Durable, Dependable 316 SS wetted components for Corrosion Resistance
- No Internal Seal used thus eliminating the possibility of process fluid leakage
- Few Moving Parts for Reduced Maintenance and long term Performance
- Excellent Serviceability and Ease of Repair with Quick-change replacement parts
- Economical small-float installation
- Displacer options for various Pressure, Specific Gravity and Interface applications
- Direct-acting or Indirect-acting simply by altering the supply and exhaust connections

Specifications

Output:	Snap Acting, Non-Bleed from 0 to Full Supply
Working Pressure:	1500 psig; available up to 5000 psig; 1500 psig with manual override
Supply Pressure:	30 psig standard; 60 psig and 100 psig available
Temperature:	-40° F to +450° F
Specific Gravity:	0.5 minimum; 0.4 minimum with counterweight; interface 0.1 differential
Materials:	316 Stainless Steel Wetted components; optional materials available
Process Connection:	2" NPT standard, 1½" NPT, Ring Bolt on P120C, 3" flanged or larger
Supply/Output Connection:	¼" NPT

P120 Common Options

- Manual Override for Field Testing
- 1½" NPT process connection
- 316 SS and 304 SS flanged
- Float Arm Extensions of 2", 4", 6" on standard body style
- Counterweight for Lower S.G.
- Extended body with horizontal or vertical displacer
- Stainless Steel Vent assembly
- Annulus Plug for use with sediments

Benefits of ALL Pathway Control Products

- Personalized service and support expertise; Responsive, On-time Delivery
- Time-tested & Proven design providing Dependable, Long-term service

P120 Series

Snap Acting Non-Bleed Pneumatic Level Control

Dimensions:

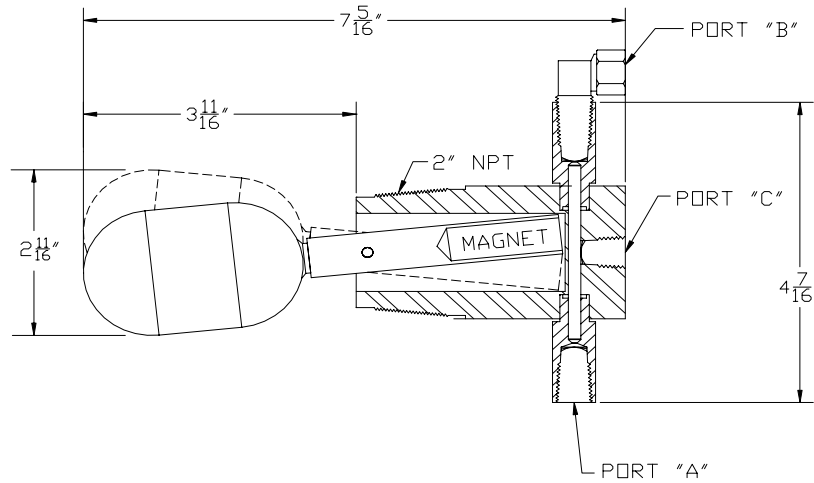

Ordering Chart:

P120 Series: Pneumatic Level Control

P120C: Ring Bolted External Cage, WP 1500 psig to 3000 psig (body style 0)

Body Style:

- 0 Ring bolted body on P120C (no manual override; no extended body)
 - 1 2" NPT standard body
 - 2 2" NPT, manual override*
 - 3 Extended body, 2" NPT, vertical displacer (type 3 or 9)
 - 6 Extended body, 2" NPT, manual override*, vertical displacer (type 3 or 9)
 - 7 Extended body, 2" NPT, horizontal displacer (type 3 or 9)
 - 8 Extended body, 2" NPT, manual override*, horizontal displacer (type 3 or 9)
- *WP 1500 psig on manual override

Displacer Type:

- 1 316 SS standard float, WP 1500 psig; 0.5 SG min (body style 0, 1, 2)
- 2 Polypropylene high pressure displacer, WP 5000 psig standard, 3000 psig on P120C; +180° F max temp; 0.6 SG min. (body style 0, 1, 2)
- 3 Interface Polypropylene displacer, WP 5000 psig standard, 3000 psig on P120C; +180° F max temp; upper fluid < .870 SG, lower fluid > .970 SG
- 4 Customer defined SG for upper and lower fluid interface
- 9 Polypropylene high pressure displacer, WP up to 5000 psig; +180° F max temp; 0.5 SG min (extended body style 3, 6, 7, 8)

Supply Pressure:

- 1 30 psig (flow rate 40 scfh at 30 psig)
- 2 60 psig (flow rate 25 scfh at 30 psig)
- 3 100 psig (flow rate 15 scfh at 30 psig)

Other:

- 0 No other options
- 2: Annulus plug
- 5: Customer Specified Requirements (see P120 common options)

Option (#): Assigned # for Customer Specific requirements

Example:

P120-

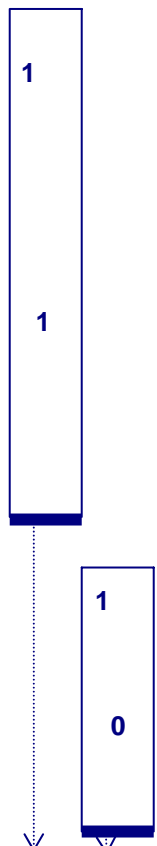

Example as Selected

P120 - 11 - 10